

SITE PLAN OF PREMISES NO - 252, ACHARYA PRAFULLA CHANDRA ROAD, KOLKATA - 700 006, WARD NO - 015, P.S.- MANIKTALA, BOROUGH - II, UNDER KOLKATA MUNICIPAL CORPORATION.

NOTE :- PREMISES NO - 252, ACHARYA PRAFULLA CHANDRA ROAD SHOWN THUS

TOTAL AREA OF LAND - 07 K.-02 CH -41 SFT. = 480.397 SQM.

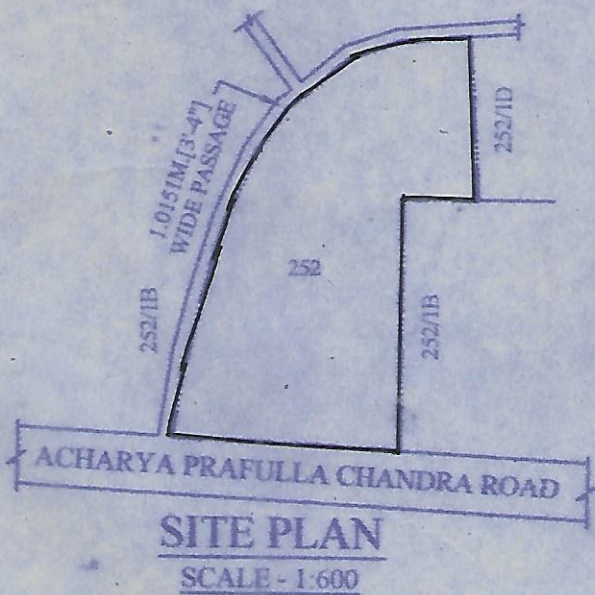
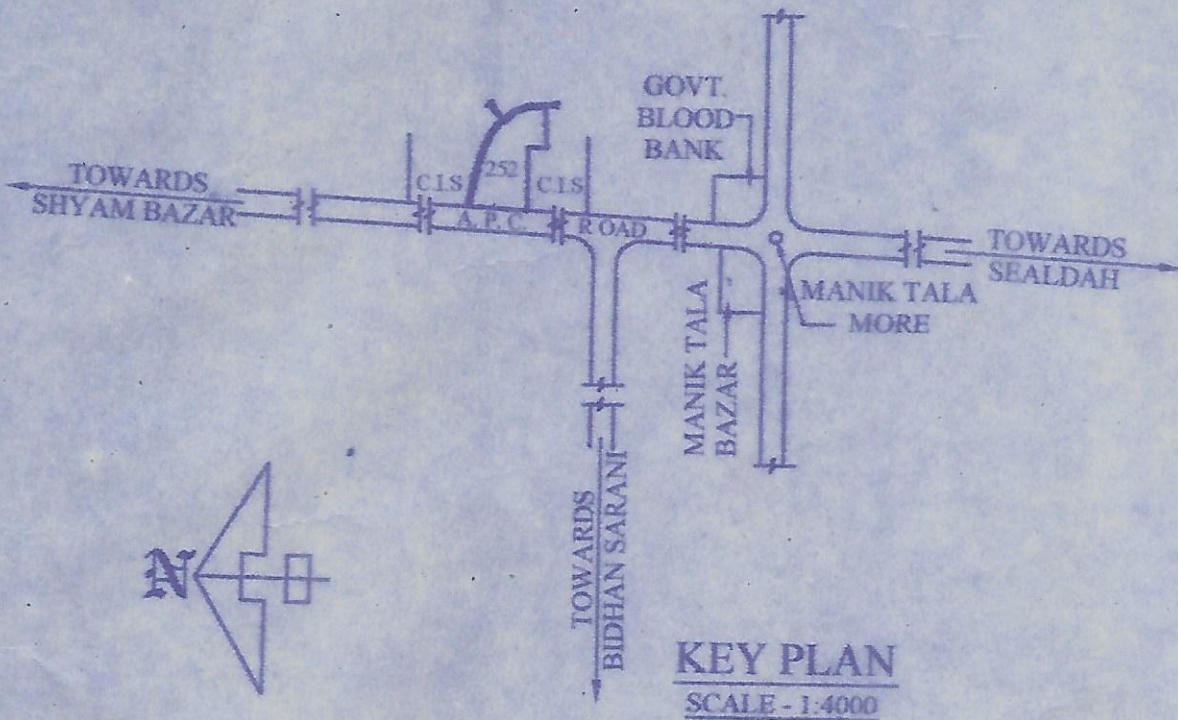

Suvarna Kumar
As Constituted Attorneys of *Mol. Ghosh*

1. SATYANARAYAN JAISWAL
2. ASHA DEVI JAISWAL
3. LAKSHMI NARAYAN JAISWAL
4. MALA JAISWAL
5. JAGDISH NARAYAN JAISWAL
6. RAJNI JAISWAL

SIG. OF OWNER'S/C.A.

Ashis Chakraborty
ASHIS CHAKRABORTY
CLASS-I L.B.S. OF
KOLKATA MUNICIPAL CORPORATION
REGN. NO-1262

SIG. OF L.B.S.